

18108 ○ Bit Holder

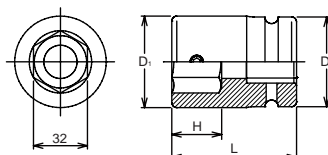

18108-SC



Replacement Screw : M8x12, ● 4mm

18108	D ₁ (mm)	D ₂ (mm)	H (mm)	L (mm)	(g)	(pcs.)
	55	54	30	75	930	2

107-32 ● Bit for Inhex Screws

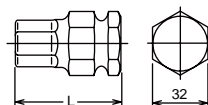

107-32 (mm)	L (mm)	(g)	(pcs.)
19	60	300	10
22	60	320	10
24	60	330	10
27	60	360	10
30	60	390	10
32	60	410	10
36	60	460	10



The items with ⚠ have larger output size than 32mm input hex drive.

18108-32 ● Bit Holder complete with Bit, Inhex

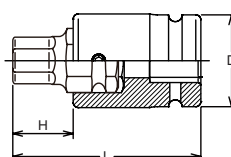

18108-32 (mm)	D (mm)	H (mm)	L (mm)	(g)	(pcs.)
19	54	30	105	1230	2
22	54	30	105	1250	2
24	54	30	105	1260	2
27	54	30	105	1290	2
30	54	30	105	1320	2
32	54	30	105	1340	2
36	54	30	105	1390	2



The items with ⚠ have larger output size than 32mm input hex drive.