

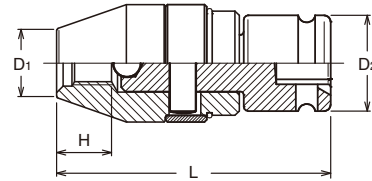

Industrial Stud Bolt Setters

23103M ○ 3/8" Sq.Dr. Stud Bolt Setter ⚠



23103M (mm)	D ₁ (mm)	D ₂ (mm)	H (mm)	L (mm)	(g)	(pcs.)
6 (1.0)	11.1	22	9	59	175	10
8 (1.25)	13.6	22	11	61	181	10
10 (1.25)	16.0	22	13	63	188	10
10 (1.5)	16.0	22	13	63	188	10

⚠ This item is not suitable for impact drivers.
 Depend on the stud bolt and tightening torque, 23103M / 24103M may cause a scratch against the stud bolts or got stuck itself during a work.

24103M ○ 1/2" Sq.Dr. Stud Bolt Setter ⚠

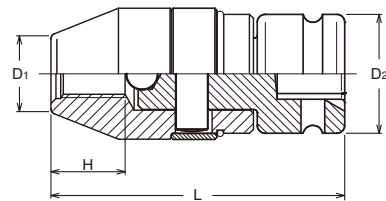

24103M (mm)	D ₁ (mm)	D ₂ (mm)	H (mm)	L (mm)	(g)	(pcs.)
8 (1.25)	15.4	30	15	69	332	10
10 (1.25)	17.8	30	18	72	344	10
10 (1.5)	17.8	30	18	72	344	10
12 (1.75)	20.2	30	19	74	352	10

⚠ This item is not suitable for impact drivers.
 Depend on the stud bolt and tightening torque, 23103M / 24103M may cause a scratch against the stud bolts or got stuck itself during a work.

The tension between a stud and stud bolt setter is easily released by turning to anticlockwise. Separated body part will be moved by sliding the pin to release position.

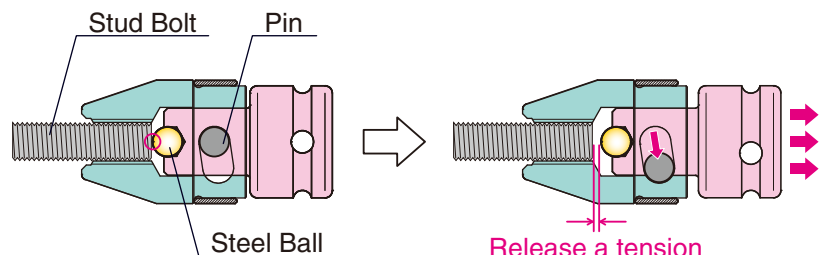

Installing a stud bolt

Removing the stud bolt setter