

DIN 3126 E11.2 Bit series

◆ 183H-35/-75 Hex Bit

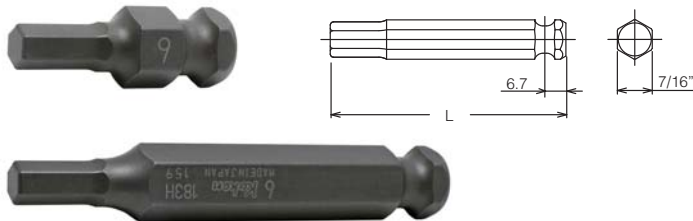

183H.35 (mm)	L (mm)	(g)	(pcs.)
3	35	15	10
4	35	15	10
5	35	15	10
6	35	18	10
7	35	19	10
8	35	20	10
10	35	26	10
12	35	30	10
14	35	35	10

183H.75 (mm)	L (mm)	(g)	(pcs.)
4	75	48	10
5	75	49	10
6	75	51	10
7	75	52	10
8	75	52	10
10	75	57	10
12	75	65	10
14	75	79	10

◆ 183T-35/-75 TORX® Bit

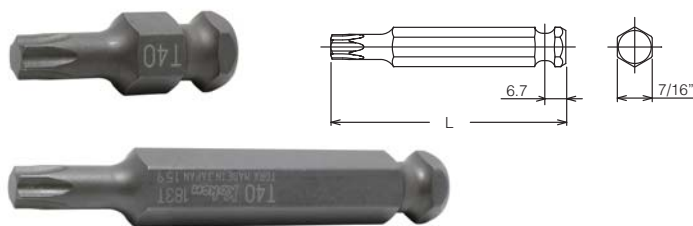

183T.35 (T)	L (mm)	(g)	(pcs.)
T30	35	18	10
T40	35	20	10
T45	35	22	10
T50	35	26	10
T55	35	30	10
T60	35	38	10

183T.75 (T)	L (mm)	(g)	(pcs.)
T30	75	48	10
T40	75	49	10
T45	75	51	10
T50	75	52	10
T55	75	57	10
T60	75	67	10

◆ 183T-35/-75(IP) TORXplus® Bit

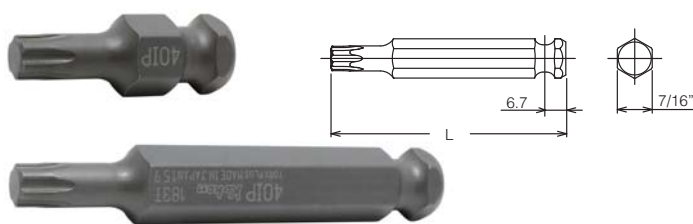

183T.35 (IP)	L (mm)	(g)	(pcs.)
30IP	35	18	10
40IP	35	20	10
45IP	35	22	10
50IP	35	26	10
55IP	35	30	10
60IP	35	38	10

183T.75 (IP)	L (mm)	(g)	(pcs.)
30IP	75	48	10
40IP	75	49	10
45IP	75	51	10
50IP	75	52	10
55IP	75	57	10
60IP	75	67	10

◆ 183X-35/-75 XZN Bit

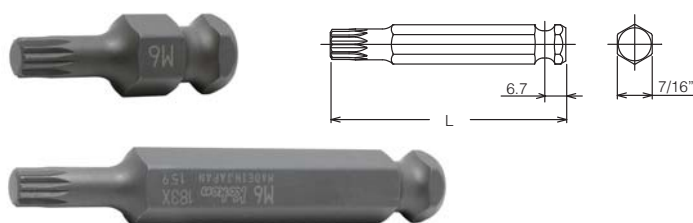

183X.35 (XZN)	L (mm)	(g)	(pcs.)
M 5	35	18	10
M 6	35	20	10
M 8	35	22	10
M10	35	26	10
M12	35	30	10
M14	35	38	10

183X.75 (XZN)	L (mm)	(g)	(pcs.)
M 5	75	48	10
M 6	75	49	10
M 8	75	51	10
M10	75	52	10
M12	75	57	10
M14	75	67	10



Novelty

DIN 3126 F11.2 Bit Holder

13134
14134 Bit Holder
16134



	□	D (mm)	L (mm)	⚖ (g)	📦 (pcs.)	⊕
13134	3/8"	22	32	70	10	*1
14134	1/2"	25	38	90	10	*2
16134	3/4"	44	52	200	2	*3

*1 C-Ring=1302C, Pin/O-Ring=1302A/B
*2 C-Ring=1401C, Pin/O-Ring=1401A/B
*3 C-Ring=1600C, Pin/O-Ring=1601A/B

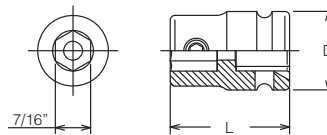

13142-F11.2
14142-F11.2 Bit Holder



	□	D ₁ (mm)	D ₂ (mm)	L (mm)	⚖ (g)	📦 (pcs.)	⊕
13142-F11.2	3/8"	18.9	22	46	116	10	*1
14142-F11.2	1/2"	18.9	25	46	207	10	*2

*1 C-Ring=1302C, Pin/O-Ring=1302A/B
*2 C-Ring=1401C, Pin/O-Ring=1401A/B

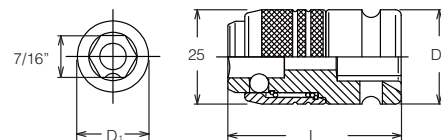

Lock & Quick Release

