

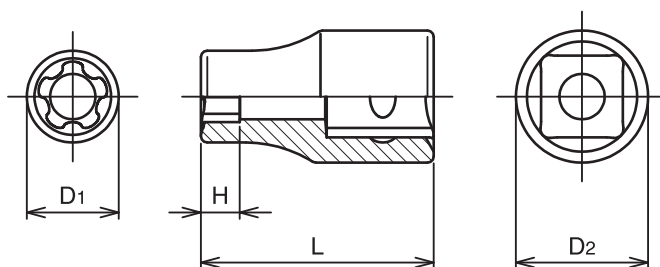







### 4425-EPRL 1/2" Sq. Dr. Hand Tamper-Resistant TORX PLUS® Sockets

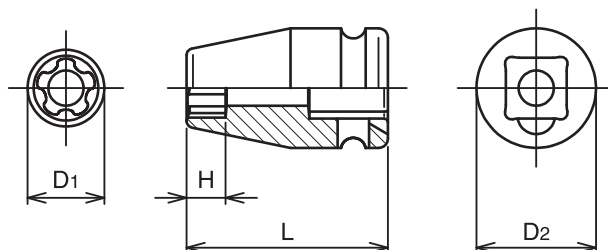

4425 (EPRL)		D <sub>1</sub> (mm)	D <sub>2</sub> (mm)	H (mm)	L (mm)	 (g)	 (pcs.)
10EPRL		13.2	21	6.2	36	45	10
12EPRL		14.6	21	7.2	37	46	10
14EPRL		16.5	21	8.1	37	47	10
20EPRL		22.9	22	11.2	37	64	10

### 13425-EPRL 3/8" Sq. Dr. Impact Tamper-Resistant TORX PLUS® Sockets



13425 (EPRL)		D <sub>1</sub> (mm)	D <sub>2</sub> (mm)	H (mm)	L (mm)	 (g)	 (pcs.)
10EPRL		12.2	19	6.2	32	41	10
12EPRL		14.2	19	7.2	32	42	10
14EPRL		17.2	19	8.1	32	43	10

EPRL Bolt



**TORX<sup>plus</sup>** is a registered trademark of **CAMCAR Innovations**.

**TORX<sup>plus</sup>** ist ein registriertes Markenzeichen der Firma **CAMCAR Innovations**.

**TORX<sup>plus</sup>** est une marque déposée de **CAMCAR Innovations**.

<http://www.koken-tool.co.jp/en/>

Reproduction in whole or in part without proper and prior authorization is prohibited.